

Welcome to your new *Office Space.*

2032 Hanley Road, Dardenne Prairie, MO 63368

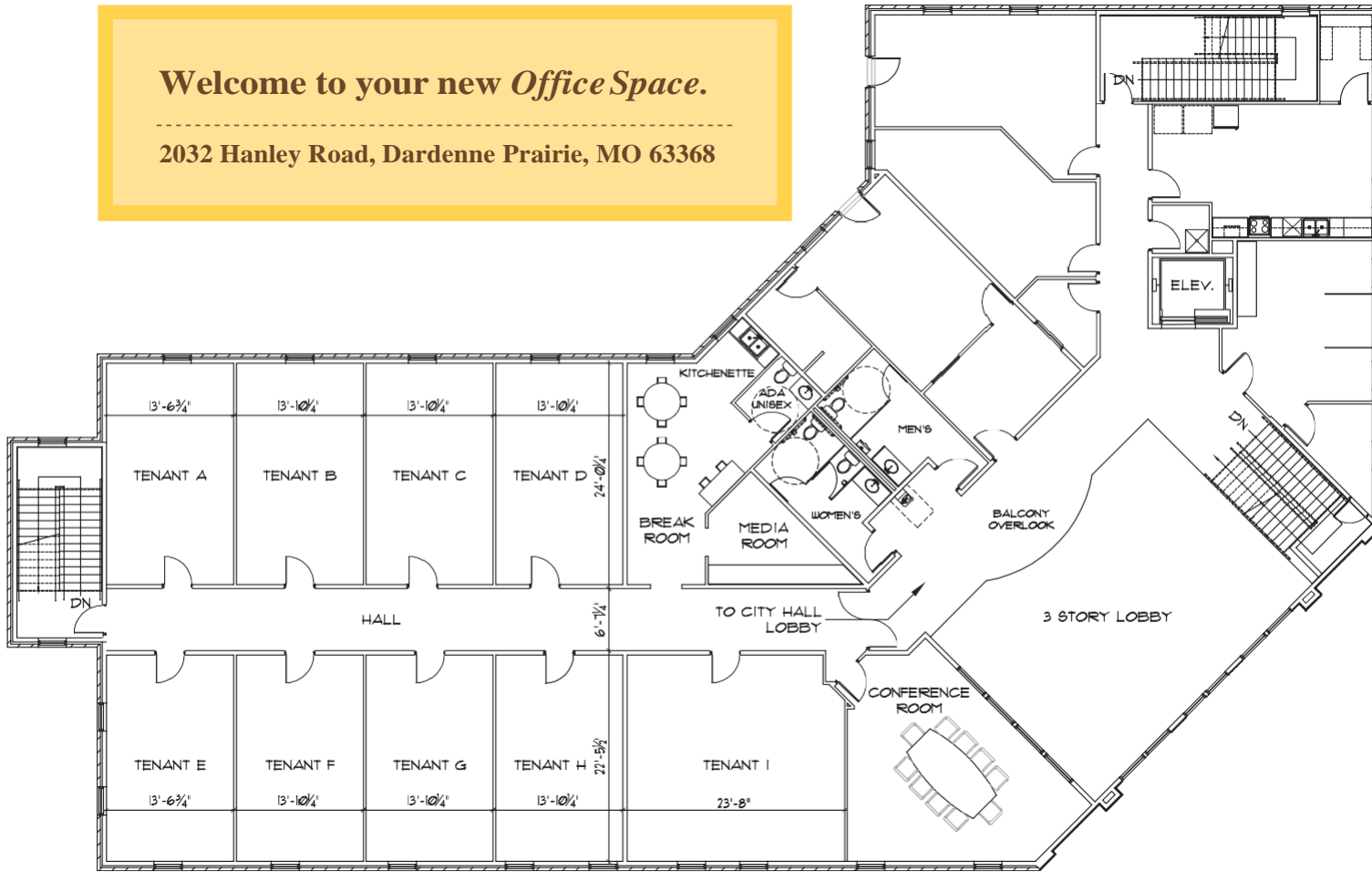

Typical White Box Standards

- (2) duplex receptacles per wall
- Carpet over gypcrete
- 2 x 4 studs @ 16" o.c. with 5/8" gyp.bd, demising walls, primed and painted
- 2 x 4 suspended lay in ceiling
- Solid core birch entry door
- Oil rubbed bronze hardware
- Fluorescent lighting

Common Amenities

- Conference room with overlook
- 3 story City Hall lobby
- Kitchenette area
- Uni-sex restroom
- Media area
- Printer/copier

Tenant Lease Space

- **tenant space - H** 303 sq. ft.
- **tenant space - F** 294 sq. ft

Step up to a professional office setting in Downtown Dardenne Prairie.

Class A office space is available in our CityHall. Office sizes range from 294 to 500 square feet with shared conference room, break room and restroom facilities. Starting at \$520.50 per month, full service. **this includes** taxes, insurance, and utilities. Phone, data connection and copies are extra.

Your clients will enter the impressive main lobby of City Hall – greeted by a professional receptionist and directed to your 2nd floor suite via the tiled ornamental iron staircase or the elevator.

Get your basement, dining room or extra bedroom back and have the professional look and exposure in a new affordable LEED certified green office building.



for more details or to view, please contact:

James Knowles
City Administrator

jknowles@dardenneprairie.org

636-755-5303